

FIRST ADDITION TO OLSON SUBDIVISION

ALL LOCATED IN THE SW1/4 OF THE NW1/4 OF SECTION 31, T11N, R3W, VILLAGE OF SOLDIERS GROVE, CRAWFORD COUNTY, WISCONSIN.

SURVEYOR'S CERTIFICATE
 I, RICHARD MARKS, DO HEREBY CERTIFY THAT I HAVE SURVEYED, DIVIDED, MAPPED AND MONUMENTED A PARCEL OF LAND LOCATED IN THE SW1/4 OF THE NW1/4 OF SECTION 31, T11N, R3W, VILLAGE OF SOLDIERS GROVE, CRAWFORD COUNTY, WISCONSIN MORE PARTICULARLY DESCRIBED AS FOLLOWS:
 BEGINNING AT A HARRISON MONUMENT AT THE WEST 1/4 OF SAID SECTION 31; THENCE N0°22'23"E ALONG THE WEST LINE OF THE SW1/4 OF SAID SECTION, 1284.48 FT.; THENCE S89°38'19"E, 229.75 FT.; THENCE S0°36'52"W, 250.99 FT.; THENCE N54°13'52"E, 171.19 FT.; THENCE S36°46'11"E, 570.00 FT.; THENCE S54°14'26"W, 38.40 FT.; THENCE S36°38'28"E, 210.21 FT.; THENCE S54°09'32"W, 813.17 FT.; THENCE S89°55'35"W 139.63 FT. TO THE POINT OF BEGINNING.
 THAT I HAVE MADE SUCH SURVEY AND LAND DIVISION UNDER THE DIRECTION OF THE OWNER'S LISTED ON SHEET 2.
 THAT I HAVE FULLY COMPLIED WITH THE PROVISIONS OF CHAPTER 236 OF THE WISCONSIN STATUTES IN SURVEYING, MAPPING AND DIVIDING THE SAME.
 THAT SUCH PLAT IS A CORRECT REPRESENTATION OF ALL THE EXTERIOR BOUNDARIES OF THE LAND SURVEYED AND SUBDIVISION THEREOF MADE AND IS ACCURATE AND CORRECT TO THE BEST OF MY KNOWLEDGE AND BELIEF.
 DATED THIS 24th DAY OF October, 2006.
 RICHARD MARKS R.L.S. #1473

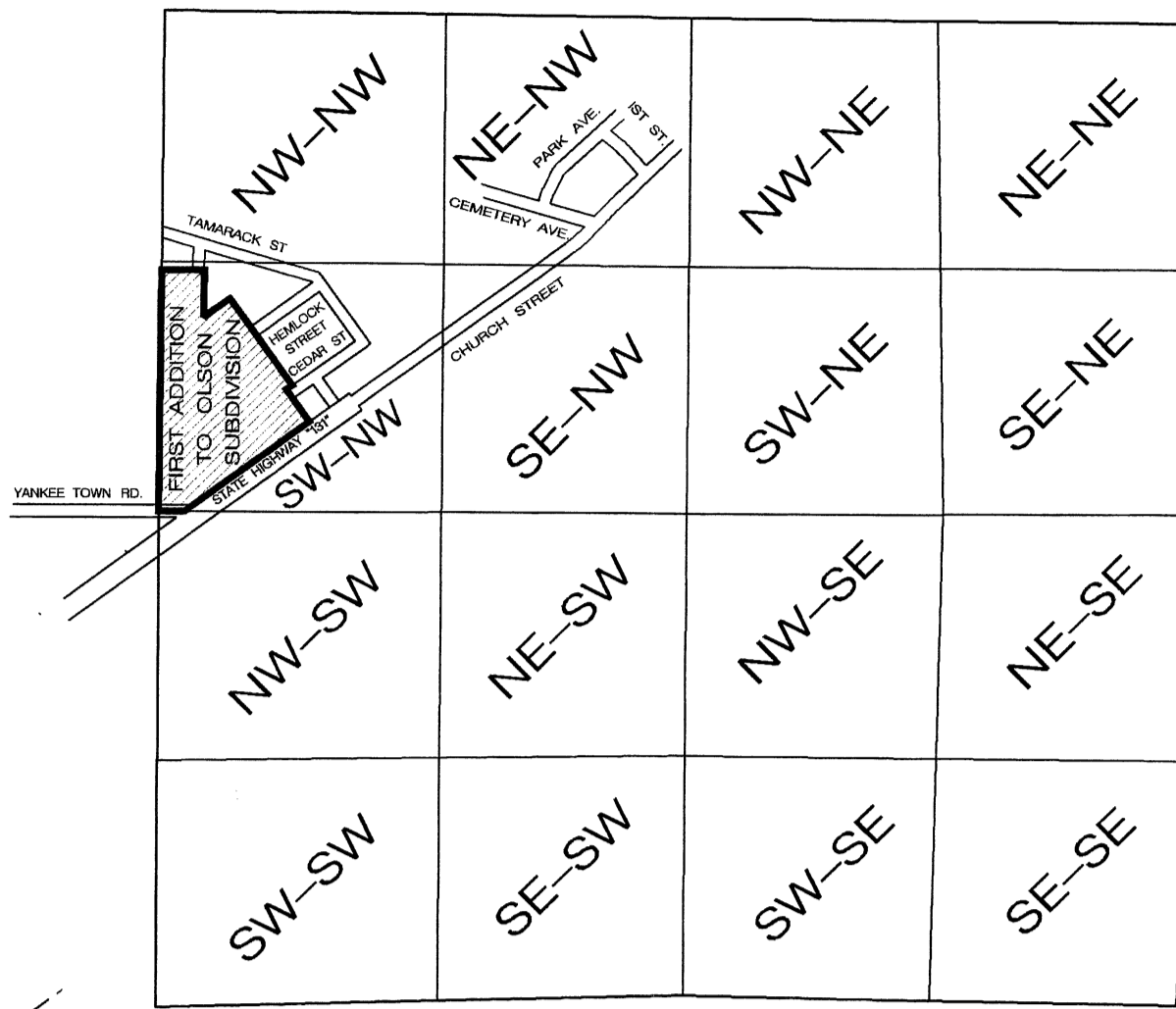

LOCATION MAP
 SCALE 1" = 1000'
SECTION 31, T11N, R3W, VILLAGE OF SOLDIERS GROVE, CRAWFORD COUNTY, WISCONSIN

- LEGEND AND NOTES**
- DENOTES 2" IRON PIPE FOUND.
 - DENOTES 1 1/4" X 30" SOLID ROUND IRON ROD WEIGHING 4.17 LBS. PER LINEAL FOOT SET.
 - NO DIRECT VEHICULAR ACCESS TO STATE HIGHWAY "131" AND YANKEE TOWN ROAD.
- ALL OTHER LOT AND OUTLOT CORNERS ARE MONUMENTED WITH 3/4" X 24" SOLID ROUND IRON RODS WEIGHING 1.50 LBS PER LINEAL FOOT SET.
- 1) BEARINGS ARE REFERENCED TO THE WEST LINE OF THE NW1/4 OF SECTION 31, T11N, R3W, ASSUMED TO BEAR N0°22'23"E.
 - 2) ALL STORM WATER DISCHARGE CREATED BY THIS PLAT MUST BE DIRECTED AWAY FROM STATE HIGHWAY "131".
 - 3) HIGHWAY SETBACKS: THIS RESTRICTION IS FOR THE BENEFIT OF THE PUBLIC AS PROVIDED IN SECTION 236.293, WISCONSIN STATUTES, AND SHALL BE ENFORCEABLE BY THE WISCONSIN DEPARTMENT OF TRANSPORTATION.
 - 4) ALL LOTS AND BLOCKS ARE HEREBY RESTRICTED SO THAT NO OWNER, POSSESSOR, USER, LICENSEE OR OTHER PERSON MAY HAVE ANY RIGHT OF DIRECT VEHICULAR INGRESS FROM OR EGRESS TO ANY HIGHWAY LYING WITHIN THE RIGHT-OF-WAY OF STATE HIGHWAY "131"; IT IS EXPRESSLY INTENDED THAT THIS RESTRICTION CONSTITUTE A RESTRICTION FOR THE BENEFIT OF THE PUBLIC AS PROVIDED IN S.236.293, STATS., AND SHALL BE ENFORCEABLE BY THE DEPARTMENT.

CURVE DATA

No.	DELTA	ARC	RADIUS	CHORD	CHORD BRG
C1	126°22'26"	33.44	15.16	27.06	S 62°34'21" E
C2	126°22'26"	83.61	37.91	67.66	N 62°34'21" W
C3	40°40'44"	26.91	37.91	26.35	S 19°43'30" W
C4	45°20'42"	30.00	37.91	29.22	S 62°44'14" E
C5	40°21'00"	26.70	37.91	26.15	N 74°24'55" E

DOC# 297263

Filed
 NOV. 16, 2006 AT 01:56PM
 CRAWFORD COUNTY WISCONSIN
 REGISTER OF DEEDS OFFICE
 MELISSA C. MEZERA - REGISTER
 Fee Amount: \$50.00

VILLAGE BOARD RESOLUTION
 RESOLVED THAT THIS PLAT OF THE FIRST ADDITION TO OLSON'S SUBDIVISION IN THE VILLAGE OF SOLDIERS GROVE, CRAWFORD COUNTY, WISCONSIN, IS HEREBY APPROVED BY THE VILLAGE OF SOLDIERS GROVE. THE PUBLIC HIGHWAY RIGHT-OF-WAY DEDICATION DESIGNATED HEREIN IS HEREBY ACKNOWLEDGED AND ACCEPTED BY THE VILLAGE OF SOLDIERS GROVE.

Steve George
 STEVE GEORGE, VILLAGE PRESIDENT

I HEREBY CERTIFY THAT THE FOREGOING IS A COPY OF A RESOLUTION ADOPTED BY THE VILLAGE BOARD OF THE VILLAGE OF SOLDIERS GROVE ON THIS 15th DAY OF November, 2006

Tamera Kepler
 TAMERA KEPLER, VILLAGE CLERK

CERTIFICATE OF THE COUNTY TREASURER
 STATE OF WISCONSIN
 CRAWFORD COUNTY
 I, MARTIN SPROSTY, BEING DULY APPOINTED, QUALIFIED AND ACTING CHIEF DEPUTY TREASURER OF CRAWFORD COUNTY, DO HEREBY CERTIFY THAT THE RECORDS IN MY OFFICE SHOW NO UNREDEEMED TAX SALES AND NO UNPAID TAXES OR SPECIAL ASSESSMENTS AS OF THIS 16th DAY OF November, 2006 AFFECTING THE PLAT OF THE FIRST ADDITION TO OLSON'S SUBDIVISION.
 DATED THIS 16th DAY OF November, 2006.
Martin E. Sprosty
 MARTIN E. SPROSTY, COUNTY TREASURER

CERTIFICATE OF THE VILLAGE TREASURER
 I, TAMERA KEPLER, BEING DULY APPOINTED, QUALIFIED AND ACTING TREASURER OF THE VILLAGE OF SOLDIERS GROVE, DO HEREBY CERTIFY THAT THE RECORDS IN MY OFFICE SHOW NO UNPAID TAXES AND NO UNPAID SPECIAL ASSESSMENTS AS OF THIS 15th DAY OF November, 2006 AFFECTING THE LANDS INCLUDED IN THIS PLAT OF THE FIRST ADDITION TO OLSON'S SUBDIVISION.
 DATED THIS 15th DAY OF November, 2006.
Tamera Kepler
 TAMERA KEPLER, VILLAGE TREASURER

There are no objections to this assessor's plat with respect to applicable provisions of s. 236.15 and 236.20 Wis. Stats.
 Certified October 19th, 2006
Rene M. Poney
 Department of Administration